

ARCTIC AIR[®] Ice Jet



INSTRUCTION MANUAL

Thank you for purchasing the Arctic Air® Ice Jet!

Customer Satisfaction is our #1 Priority,

but if you are not satisfied for any reason, please contact us directly.

ArcticAirIceJet@rephelpdesk.com

WHAT'S INCLUDED:

RIGHT SIDE

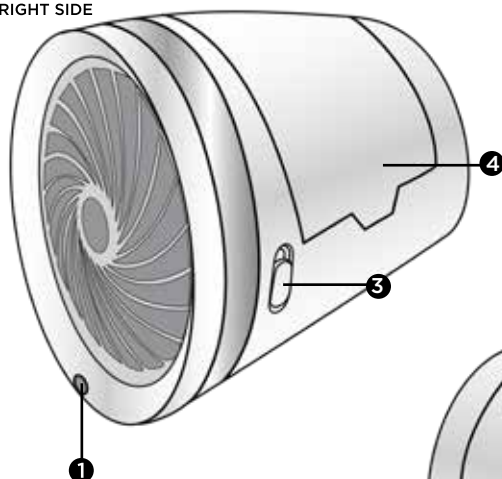

LEFT SIDE

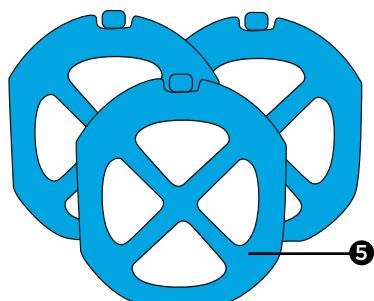
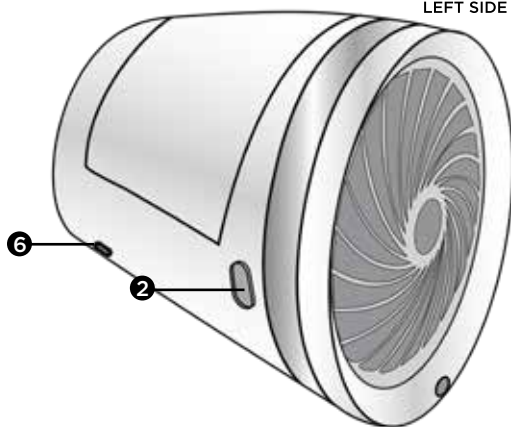

1. Power Button
2. Moodlight Button
3. Adjustable Grill Switch
4. Ice Pack Door

5. Ice Packs (3 included)
6. Power Port
7. Power Cable
8. Ice Boost Powder (3 included)

FILLING ICE PACKS:

1. Remove twist off cap located on top of Ice Packs.



2. Cut open Ice Boost Powder pack and carefully pour into Ice Pack. Use one Ice Boost Powder pack per Ice Pack.

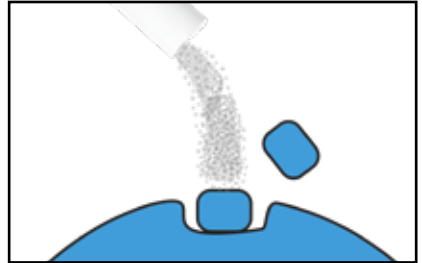

3. Fill with water until you reach the top of the Ice Pack.



4. Replace cap until hand tight, and gently shake to mix.

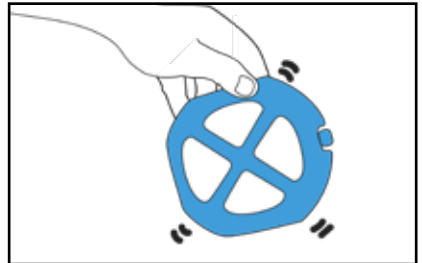

5. Freeze Ice Packs for approximately one hour before use, or until completely frozen.

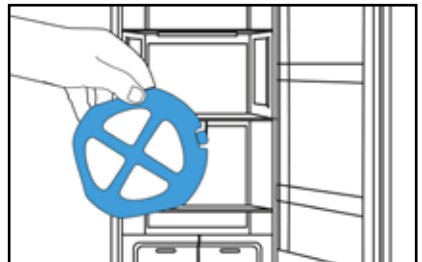

USING ICE JET:

1. Plug small USB-C end of Power Cord into the side of the unit, and the large USB end into a power adapter (not included).

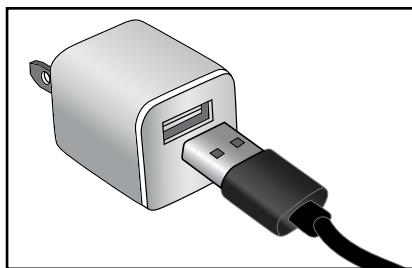

2. Open Ice Pack door and insert Ice Packs into slots, with cap facing up. Close Ice Pack Door when done.

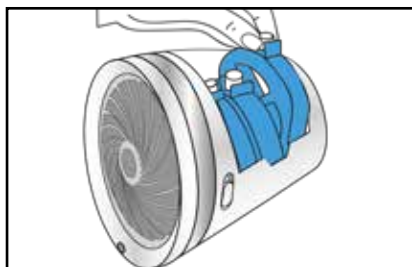

NOTE: For best cooling and quick results, use all three ice packs at the same time. For longer, less intense cooling, use one or two ice packs at the same time, and leave the remaining Ice Packs in freezer until ready to use.

3. Press the Power Button to turn on, and select desired fan speed.

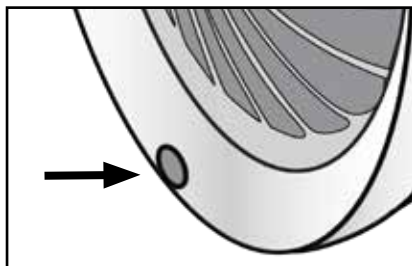

4. To turn on/off or change moodlight color, use the Moodlight Button located on the side of Ice Jet.

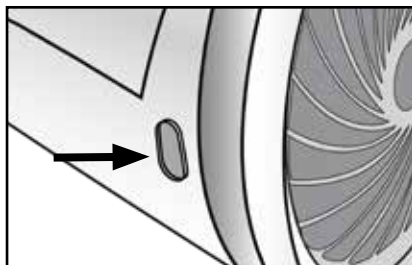

USING ICE JET (continued):

5. To adjust airflow direction, use the Adjustable Grill Switch on the side of Ice Jet.
6. When done, place the Ice Packs back into the freezer until next use. Store your Ice Jet in a cool, dry place until ready to use again.

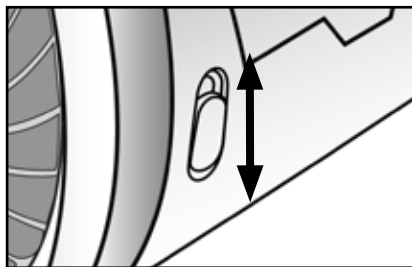

CARE AND CLEANING:

After each use, be sure to use a dry, soft cloth to wipe up any condensation that may have formed during use.

Spot clean with cloth as needed. Do not submerge unit in water.

WARNINGS:

- Before not using Arctic Air Ice Jet for extended periods of time, remove ice packs, and set unit on highest fan speed for 2 hours. This will dry out the unit prior to storage.
- Only use the original cord supplied in package.
- Do not touch the power supply or power cord with wet hands.
- Unplug Arctic Air® Ice Jet when cleaning or moving the device.
- For best results, place Arctic Air® Ice Jet on a higher surface like a table or counter top.
- Do not place Arctic Air® Ice Jet near a heater or any electrical equipment.
- Do not place the device in passageways or high traffic areas where there is a possibility of tripping or knocking it over.
- Do not allow any foreign objects inside Arctic Air® Ice Jet.
- Do not place items on top Arctic Air® Ice Jet.
- Do not block the front and back grills of the device.

WARNINGS (continued):

- Do not turn the device upside down.
- Do not submerge the Arctic Air® Ice Jet under water or other liquids.
- Do not place Arctic Air® Ice Jet near open flames or fire sources.
- People with limited physical, visual or mental abilities or lacking proper experience and/or knowledge should never use the device without supervision of those responsible for their safety or those capable of assistance in using the device.
- The device can be switched off completely only when disconnected from the power supply.
- The manufacturer does not bear any responsibility for any damage from failure to comply with this product guide.
- Do not ingest Ice Boost Powder. Only use as directed in this manual.

ONTEL® ASSUMES NO RESPONSIBILITY FOR ANY INCIDENTAL OR CONSEQUENTIAL DAMAGES ARISING OUT OF YOUR USE OF THE PRODUCT. IN PURCHASING AND USING THIS PRODUCT, YOU ASSUME ALL RESPONSIBILITY FOR CLEANING THE PRODUCT AND MONITORING THE PRODUCT FOR MOLD. ADDITIONALLY, ONTEL® SPECIFICALLY DISCLAIMS ALL EXPRESSED WARRANTIES NOT OTHERWISE SET FORTH HEREIN AND ANY IMPLIED WARRANTIES OF MERCHANTABILITY OR FITNESS FOR A PARTICULAR PURPOSE. THERE ARE NO WARRANTIES WHICH EXTEND BEYOND THE DESCRIPTION OF THE FACE HEREOF.

FCC Statement

This device complies with Part 15 of the FCC Rules. Operation is subject to the following two conditions: (1) this device may not cause harmful interference, and (2) this device must accept any interference received, including interference that may cause undesired operation.

Warning: Changes or modifications to this unit not expressly approved by the party responsible for compliance could void the user's authority to operate the equipment.

NOTE: This equipment has been tested and found to comply with the limits for a Class B digital device, pursuant to Part 15 of the FCC Rules.

These limits are designed to provide reasonable protection against harmful interference in a residential installation. This equipment generates, uses and can radiate radio frequency energy and, if not installed and used in accordance with the instructions, may cause harmful interference to radio communications. However, there is no guarantee that interference will not occur in a particular installation. If this equipment does cause harmful interference to radio or television reception, which can be determined by turning the equipment off and on, the user is encouraged to try to correct the interference by one or more of the following measures:

- Reorient or relocate the receiving antenna.
- Increase the separation between the equipment and receiver.
- Connect the equipment into an outlet on a circuit different from that to which the receiver is connected.
- Consult the dealer or an experienced radio/TV technician for help.

FOR BEST RESULTS:

FREEZE ICE PACKS WITH ICE BOOST POWDER

Pour Ice Boost Powder into Ice Packs. Fill Ice Packs with water, replace the cap and shake Ice Packs to mix. Place in Freezer until frozen.

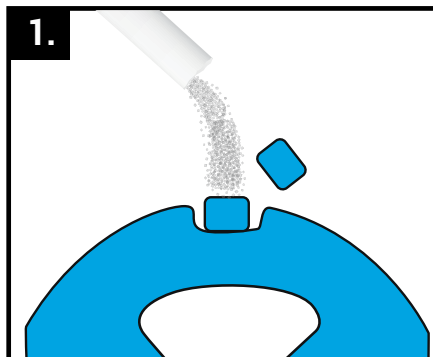

FOR MAXIMUM COOLING

For maximum cooling, use all three frozen Ice Packs with Ice Boost Powder at the same time.

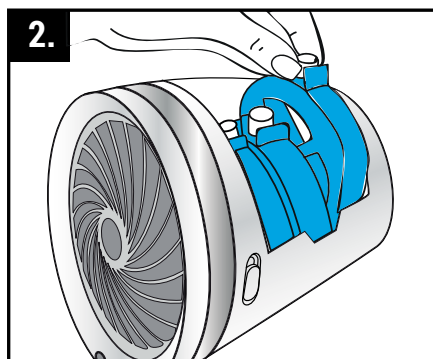

FOR MAXIMUM RUN TIME

For maximum run time, use one or two frozen Ice Packs at the same time and leave the remaining Ice Packs in the freezer until ready to use.

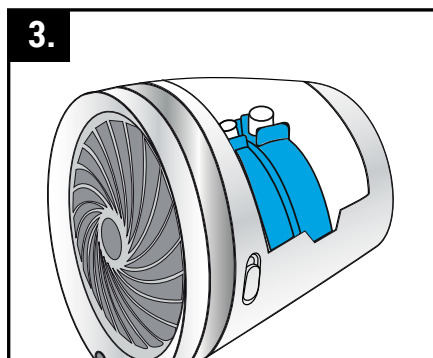



©2023 Ontel Products Corp.
21 Law Drive,
Fairfield, NJ 07004
All Rights Reserved.
Made In China.

FOR HOUSEHOLD USE ONLY
FOR INDOOR USE ONLY
Model Number: XXX
DC5V, 1.8 - 2.0A

Made In China
AAIJ-IM-01-1123-200